

**ALL GOVERNMENT APPROVALS**

**PRE-LAUNCH OFFER**  
**₹ 4,999\*** per Sq.ft  
*Limited Offer*

**BANK LOAN AVAILABLE**

Strategic Partner  
**JEEVANA NIDHI**  
 DEVELOPERS & CONSTRUCTIONS  
 msrama2011@gmail.com  
 Office Address: #111, 2nd Floor, Susheelamma Layout, Puttena Halli, Yelahanka, Bengaluru - 560 064



Scan for Location



**PRAKRUTHI JEEVANANIDHI ENCLAVE**

**LAYOUT PLAN**

**PRAKRUTHI JEEVANANIDHI ENCLAVE**

Sy. No. 95/2 & 96/5, Madappanahalli, Hesaraghatta Hobli, Yelahanka Taluk, Bengaluru

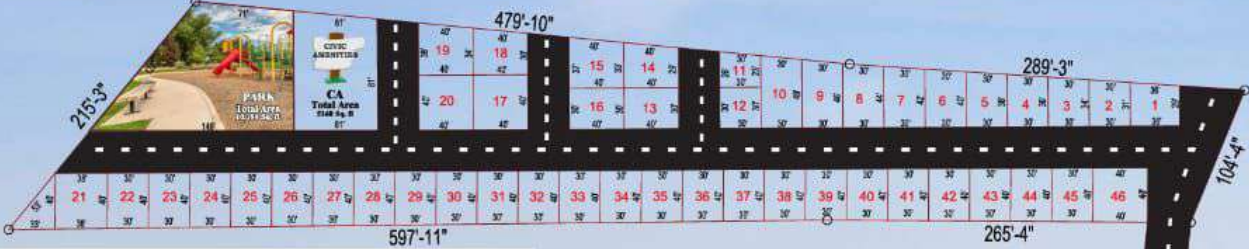

**AMENITIES**

- Compound Wall
- Box Drainage
- Electricity, Street Lights & Transformer
- Water pipe lines for each plot
- Under Ground sewage supply
- Sanitary Pit
- Park & plantation
- Childrens Play Area
- Cement Roads(White Topping)

Hesaraghatta & Presidency University

Yelahanka RTO Office

**DISTANCE INDICATOR**



**AMENITIES**

